



Parkwood

DUBAI HILLS ESTATE

EMAAR

FS
REAL ESTATE
STAY AHEAD, INVEST SMART

db
DUBRICKS
POSSIBILITIES ARE LIMITLESS



Parkwood

DUBAI HILLS ESTATE

— INTERIORS BY VIDA —

1 BEDROOM TYPE A TOWER A

UNIT 102, 202, 302, 402, 502, 602, 702, 802, 902, 1002, 1102,
1202, 1302, 1402, 1502, 1602, 1702, 1802, 1902, 2002

SUITE AREA 694.19 SQ.FT. 64.49 SQ.M.

BALCONY AREA 130.03 SQ.FT. 12.08 SQ.M.

TOTAL AREA 824.22 SQ.FT. 76.57 SQ.M.

UNIT 103, 203, 303, 403, 503, 603, 703, 803, 903, 1003, 1103,
1203, 1303, 1403, 1503, 1603, 1703, 1803, 1903, 2003

SUITE AREA 703.10 SQ.FT. 65.32 SQ.M.

BALCONY AREA 126.91 SQ.FT. 11.79 SQ.M.

TOTAL AREA 830.01 SQ.FT. 77.11 SQ.M.



KEY SECTION

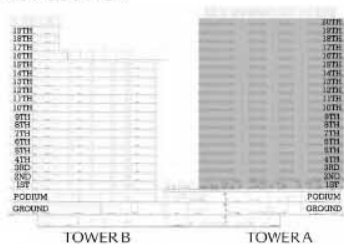

KEYPLAN

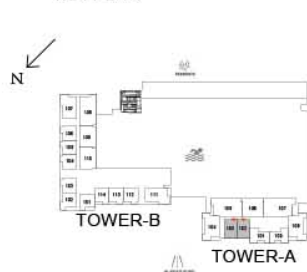

LEVEL 1

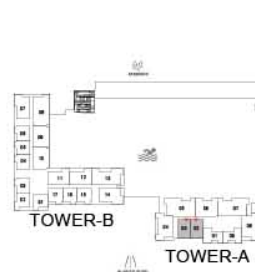

LEVELS 2-15

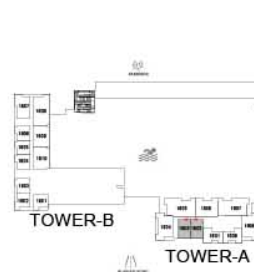

LEVEL 16



LEVELS 17-19

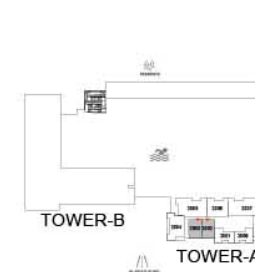

LEVEL 20

FLOOR PLAN 1. All dimensions are in imperial and metric, and measured from finish to finish excluding construction tolerances. 2. All materials, dimensions, and drawings are approximate only. 3. Information is subject to change without notice, at developer's absolute discretion. 4. Actual area may vary from the stated area. 5. Drawings not to scale. 6. All images used are for illustrative purposes only and do not represent the actual size, features, specifications, fittings, and furnishings. 7. The developer reserves the right to make revisions / alterations, at its absolute discretion, without any liability whatsoever.

EMAAR

Parkwood

DUBAI HILLS ESTATE

— INTERIORS BY VIDA —

1 BEDROOM TYPE B TOWER A

UNIT P01, 101, 201, 301, 401, 501, 601, 701, 801, 901, 1001,
1101, 1201, 1301, 1401, 1501, 1601, 1701, 1801, 1901, 2001

SUITE AREA 637.18 SQ.FT. 59.20 SQ.M.

BALCONY AREA 125.25 SQ.FT. 11.63 SQ.M.

TOTAL AREA 762.43 SQ.FT. 70.83 SQ.M.



KEY SECTION

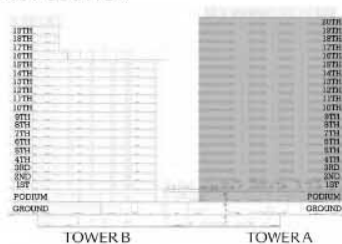

KEYPLAN

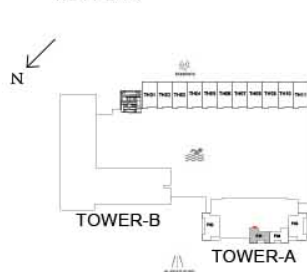

PODIUM LEVEL

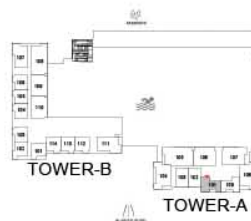

LEVEL 1

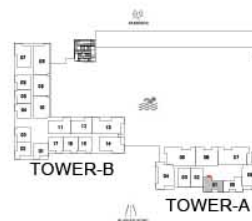

LEVELS 2-15

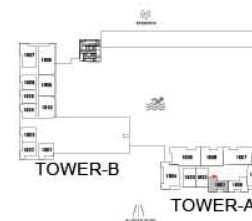

LEVEL 16



LEVELS 17-19

FLOOR PLAN 1. All dimensions are in imperial and metric, and measured from finish to finish excluding construction tolerances. 2. All materials, dimensions, and drawings are approximate only. 3. Information is subject to change without notice, at developer's absolute discretion. 4. Actual area may vary from the stated area. 5. Drawings not to scale. 6. All images used are for illustrative purposes only and do not represent the actual size, features, specifications, fittings, and furnishings. 7. The developer reserves the right to make revisions / alterations, at its absolute discretion, without any liability whatsoever.

EMAAR

Parkwood

DUBAI HILLS ESTATE

— INTERIORS BY VIDA —

1 BEDROOM TYPE B1 TOWER A

UNIT P04, 109, 209, 309, 409, 509, 609, 709, 809, 909, 1009,
1109, 1209, 1309, 1409, 1509, 1609, 1709, 1809, 1909, 2009

SUITE AREA 638.90 SQ.FT. 59.35 SQ.M.

BALCONY AREA 125.25 SQ.FT. 11.64 SQ.M.

TOTAL AREA 764.15 SQ.FT. 70.99 SQ.M.



KEY SECTION

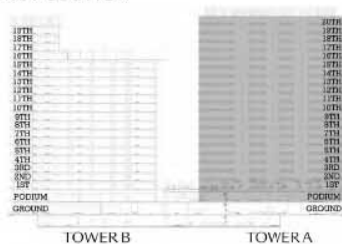

KEYPLAN

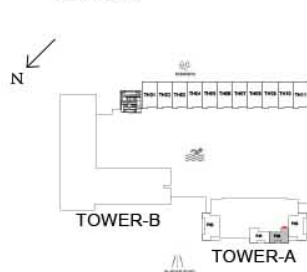

PODIUM LEVEL

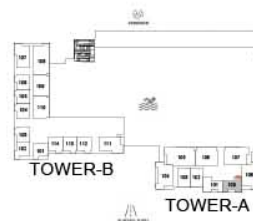

LEVEL 1

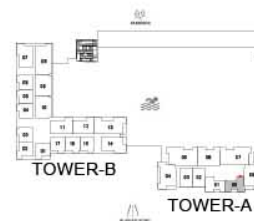

LEVELS 2-15

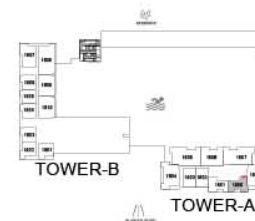

LEVEL 16



LEVELS 17-19

FLOOR PLAN 1. All dimensions are in imperial and metric, and measured from finish to finish excluding construction tolerances. 2. All materials, dimensions, and drawings are approximate only. 3. Information is subject to change without notice, at developer's absolute discretion. 4. Actual area may vary from the stated area. 5. Drawings not to scale. 6. All images used are for illustrative purposes only and do not represent the actual size, features, specifications, fittings, and furnishings. 7. The developer reserves the right to make revisions / alterations, at it's absolute discretion, without any liability whatsoever.

EMAAR

Parkwood

DUBAI HILLS ESTATE

— INTERIORS BY VIDA —

2 BEDROOM TYPE A TOWER A

	UNIT P02	
SUITE AREA	1095.87 SQ.FT.	101.81 SQ.M.
BALCONY AREA	213.01 SQ.FT.	19.79 SQ.M.
TOTAL AREA	1308.88 SQ.FT.	121.60 SQ.M.
UNIT	204, 304, 404, 504, 604, 704, 804, 904, 1004, 1104, 1204, 1304, 1404, 1504, 1604, 1704, 1804, 1904, 2004	
SUITE AREA	1095.87 SQ.FT.	101.81 SQ.M.
BALCONY AREA	213.77 SQ.FT.	19.86 SQ.M.
TOTAL AREA	1309.64 SQ.FT.	121.67 SQ.M.



KEY SECTION

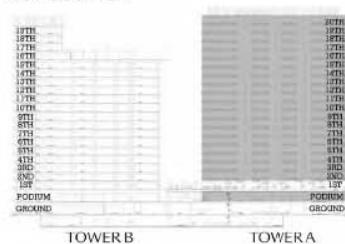

KEYPLAN

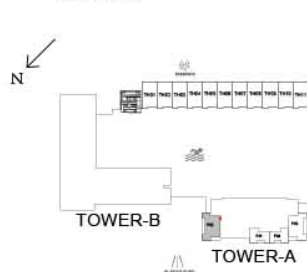

PODIUM LEVEL

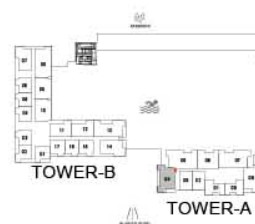

LEVELS 2-15

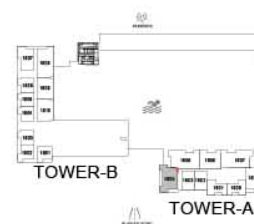

LEVEL 16

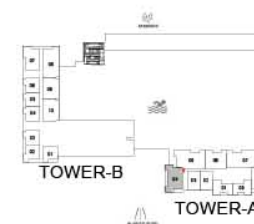

LEVELS 17-19

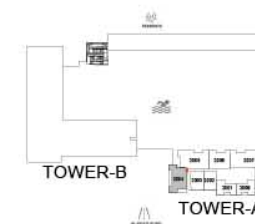

LEVEL 20

FLOOR PLAN 1. All dimensions are in imperial and metric, and measured from finish to finish excluding construction tolerances. 2. All materials, dimensions, and drawings are approximate only. 3. Information is subject to change without notice, at developer's absolute discretion. 4. Actual area may vary from the stated area. 5. Drawings not to scale. 6. All images used are for illustrative purposes only and do not represent the actual size, features, specifications, fittings, and furnishings. 7. The developer reserves the right to make revisions / alterations, at it's absolute discretion, without any liability whatsoever.

EMAAR

Parkwood

DUBAI HILLS ESTATE

— INTERIORS BY VIDA —

2 BEDROOM TYPE A1 TOWER A

UNIT P03, 108, 208, 308, 408, 508, 608, 708, 808, 908, 1008,
1108, 1208, 1308, 1408, 1508, 1608, 1708, 1808, 1908, 2008

SUITE AREA 1087.95 SQ.FT. 101.07 SQ.M.

BALCONY AREA 213.43 SQ.FT. 19.83 SQ.M.

TOTAL AREA 1301.38 SQ.FT. 120.90 SQ.M.



KEY SECTION

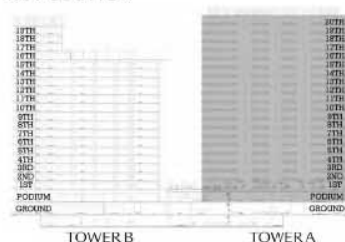

KEYPLAN

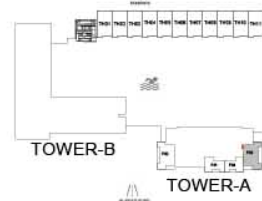

PODIUM LEVEL

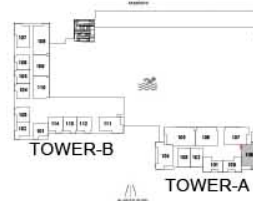

LEVEL 1



LEVELS 2-15

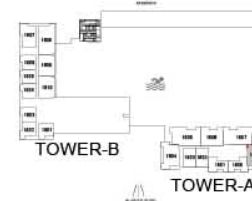

LEVEL 16

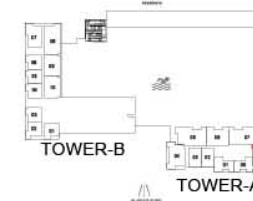

LEVELS 17-19



LEVEL 20

FLOOR PLAN 1. All dimensions are in imperial and metric, and measured from finish to finish excluding construction tolerances. 2. All materials, dimensions, and drawings are approximate only. 3. Information is subject to change without notice, at developer's absolute discretion. 4. Actual area may vary from the stated area. 5. Drawings not to scale. 6. All images used are for illustrative purposes only and do not represent the actual size, features, specifications, fittings, and furnishings. 7. The developer reserves the right to make revisions / alterations, at its absolute discretion, without any liability whatsoever.

EMAAR

Parkwood

DUBAI HILLS ESTATE

— INTERIORS BY VIDA —

2 BEDROOM TYPE A2 TOWER A

UNIT 104

SUITE AREA	1096.52 SQ.FT.	101.87 SQ.M.
BALCONY AREA	257.90 SQ.FT.	23.96 SQ.M.
TOTAL AREA	1354.42 SQ.FT.	125.83 SQ.M.



KEY SECTION

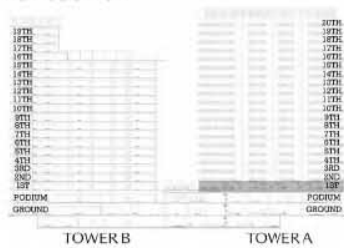

KEYPLAN

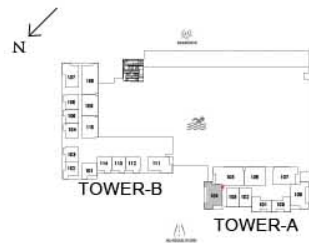

LEVEL 1

FLOOR PLAN 1. All dimensions are in imperial and metric, and measured from finish to finish excluding construction tolerances. 2. All materials, dimensions, and drawings are approximate only. 3. Information is subject to change without notice, at developer's absolute discretion. 4. Actual area may vary from the stated area. 5. Drawings not to scale. 6. All images used are for illustrative purposes only and do not represent the actual size, features, specifications, fittings, and furnishings. 7. The developer reserves the right to make revisions / alterations, at its absolute discretion, without any liability whatsoever.

EMAAR

Parkwood

DUBAI HILLS ESTATE

— INTERIORS BY VIDA —

2 BEDROOM TYPE B TOWER A

UNIT 206, 306, 406, 506, 606, 706, 806, 906, 1006, 1106,
1206, 1306, 1406, 1506, 1606, 1706, 1806, 1906, 2006

SUITE AREA	1100.18 SQ.FT.	102.21 SQ.M.
BALCONY AREA	133.04 SQ.FT.	12.36 SQ.M.
TOTAL AREA	1233.22 SQ.FT.	114.57 SQ.M.



KEY SECTION

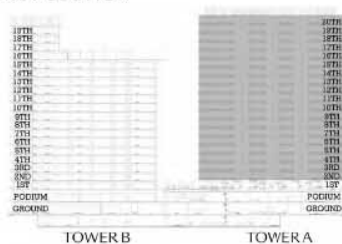

KEYPLAN

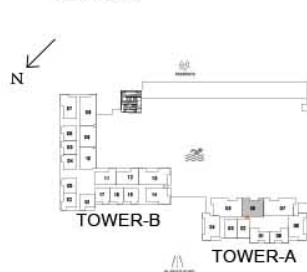

LEVELS 2-15

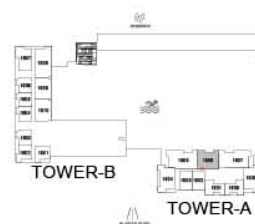

LEVEL 16

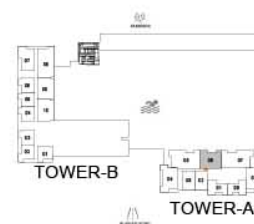

LEVELS 17-19

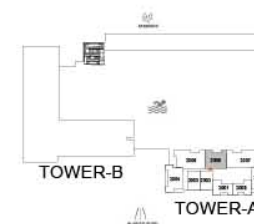

LEVEL 20

FLOOR PLAN 1. All dimensions are in imperial and metric, and measured from finish to finish excluding construction tolerances. 2. All materials, dimensions, and drawings are approximate only. 3. Information is subject to change without notice, at developer's absolute discretion. 4. Actual area may vary from the stated area. 5. Drawings not to scale. 6. All images used are for illustrative purposes only and do not represent the actual size, features, specifications, fittings, and furnishings. 7. The developer reserves the right to make revisions / alterations, at its absolute discretion, without any liability whatsoever.

EMAAR

Parkwood

DUBAI HILLS ESTATE

— INTERIORS BY VIDA —

2 BEDROOM TYPE B1 TOWER A

UNIT 106

SUITE AREA	1100.29 SQ.FT.	102.22 SQ.M.
BALCONY AREA	256.72 SQ.FT.	23.85 SQ.M.
TOTAL AREA	1357.01 SQ.FT.	126.07 SQ.M.



KEY SECTION

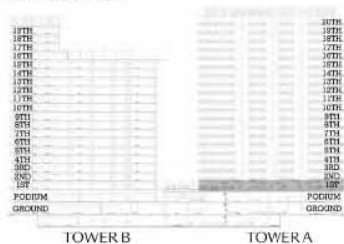

KEYPLAN

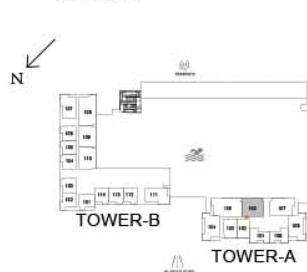

LEVEL 1

FLOOR PLAN 1. All dimensions are in imperial and metric, and measured from finish to finish excluding construction tolerances. 2. All materials, dimensions, and drawings are approximate only. 3. Information is subject to change without notice, at developer's absolute discretion. 4. Actual area may vary from the stated area. 5. Drawings not to scale. 6. All images used are for illustrative purposes only and do not represent the actual size, features, specifications, fittings, and furnishings. 7. The developer reserves the right to make revisions / alterations, at its absolute discretion, without any liability whatsoever.

EMAAR

Parkwood

DUBAI HILLS ESTATE

— INTERIORS BY VIDA —

2 BEDROOM TYPE C TOWER A

UNIT 107

SUITE AREA	1120.31 SQ.FT.	104.08 SQ.M.
BALCONY AREA	387.50 SQ.FT.	36.00 SQ.M.
TOTAL AREA	1507.81 SQ.FT.	140.08 SQ.M.



KEY SECTION

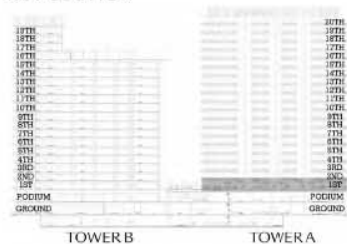

KEYPLAN

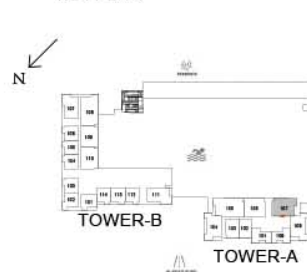

LEVEL 1

FLOOR PLAN 1. All dimensions are in imperial and metric, and measured from finish to finish excluding construction tolerances. 2. All materials, dimensions, and drawings are approximate only. 3. Information is subject to change without notice, at developer's absolute discretion. 4. Actual area may vary from the stated area. 5. Drawings not to scale. 6. All images used are for illustrative purposes only and do not represent the actual size, features, specifications, fittings, and furnishings. 7. The developer reserves the right to make revisions / alterations, at it's absolute discretion, without any liability whatsoever.

EMAAR

Parkwood

DUBAI HILLS ESTATE

— INTERIORS BY VIDA —

3 BEDROOM TYPE A TOWER A

UNIT 205, 305, 405, 505, 605, 705, 805, 905, 1005, 1105,
1205, 1305, 1405, 1505, 1605, 1705, 1805, 1905, 2005

SUITE AREA 1488.33 SQ.FT. 138.27 SQ.M.

BALCONY AREA 317.75 SQ.FT. 29.52 SQ.M.

TOTAL AREA 1806.08 SQ.FT. 167.79 SQ.M.



KEY SECTION

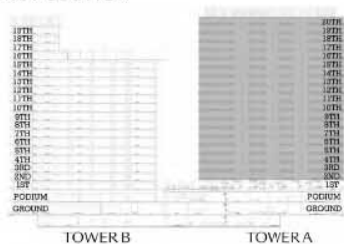

KEYPLAN

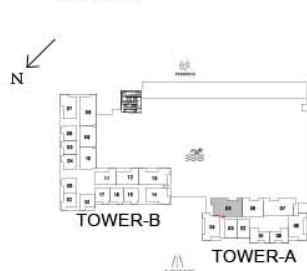

LEVELS 2-15

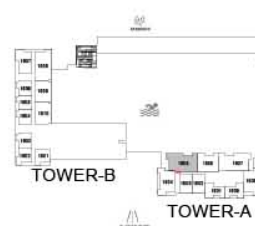

LEVEL 16

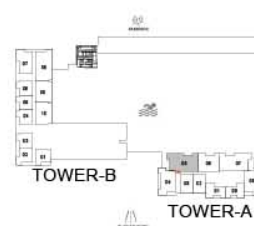

LEVELS 17-19

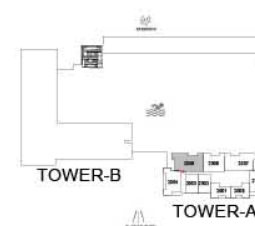

LEVEL 20

FLOOR PLAN 1. All dimensions are in imperial and metric, and measured from finish to finish excluding construction tolerances. 2. All materials, dimensions, and drawings are approximate only. 3. Information is subject to change without notice, at developer's absolute discretion. 4. Actual area may vary from the stated area. 5. Drawings not to scale. 6. All images used are for illustrative purposes only and do not represent the actual size, features, specifications, fittings, and furnishings. 7. The developer reserves the right to make revisions / alterations, at its absolute discretion, without any liability whatsoever.

EMAAR

Parkwood

DUBAI HILLS ESTATE

— INTERIORS BY VIDA —

3 BEDROOM TYPE A1 TOWER A

UNIT 105

SUITE AREA	1493.92 SQ.FT.	138.79 SQ.M.
BALCONY AREA	450.15 SQ.FT.	41.82 SQ.M.
TOTAL AREA	1944.07 SQ.FT.	180.61 SQ.M.



KEY SECTION

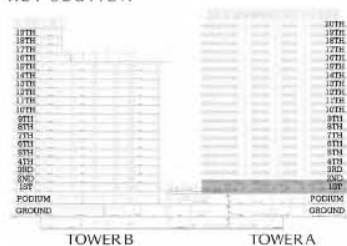

KEYPLAN

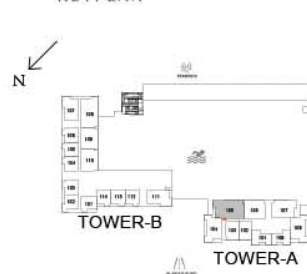

LEVEL 1

FLOOR PLAN 1. All dimensions are in imperial and metric, and measured from finish to finish excluding construction tolerances. 2. All materials, dimensions, and drawings are approximate only. 3. Information is subject to change without notice, at developer's absolute discretion. 4. Actual area may vary from the stated area. 5. Drawings not to scale. 6. All images used are for illustrative purposes only and do not represent the actual size, features, specifications, fittings, and furnishings. 7. The developer reserves the right to make revisions / alterations, at it's absolute discretion, without any liability whatsoever.

EMAAR

Parkwood

DUBAI HILLS ESTATE

— INTERIORS BY VIDA —

3 BEDROOM TYPE A2 TOWER A

UNIT 207, 307, 407, 507, 607, 707, 807, 907, 1007, 1107,
1207, 1307, 1407, 1507, 1607, 1707, 1807, 1907, 2007

SUITE AREA	1493.38 SQ.FT.	138.74 SQ.M.
BALCONY AREA	314.20 SQ.FT.	29.19 SQ.M.
TOTAL AREA	1807.58 SQ.FT.	167.93 SQ.M.



KEY SECTION

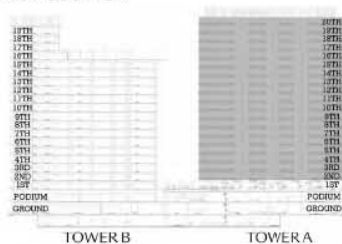

KEYPLAN

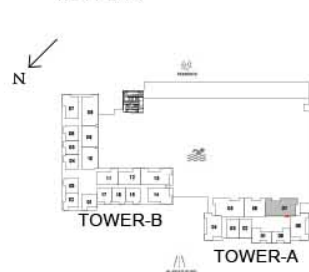

LEVELS 2-15

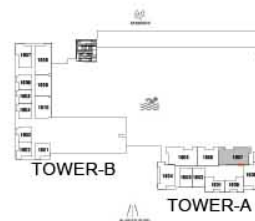

LEVEL 16

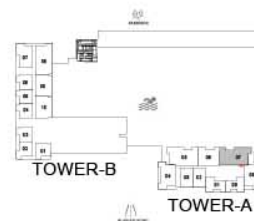

LEVELS 17-19

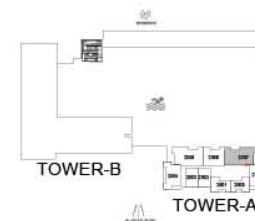

LEVEL 20

FLOOR PLAN 1. All dimensions are in imperial and metric, and measured from finish to finish excluding construction tolerances. 2. All materials, dimensions, and drawings are approximate only. 3. Information is subject to change without notice, at developer's absolute discretion. 4. Actual area may vary from the stated area. 5. Drawings not to scale. 6. All images used are for illustrative purposes only and do not represent the actual size, features, specifications, fittings, and furnishings. 7. The developer reserves the right to make revisions / alterations, at its absolute discretion, without any liability whatsoever.

EMAAR



Parkwood

DUBAI HILLS ESTATE

FOR MORE INFORMATION PLEASE CONTACT



REAL ESTATE

STAY AHEAD, INVEST SMART

📞 +971 55 476 7630
☎ +971 4 368 7878
✉ info@afsrealestate.com
🌐 www.afsrealestate.com



DUBRICKS

POSSIBILITIES ARE LIMITLESS

📞 +971 50 674 2020
☎ +971 4 397 7731
✉ info@dubricks.com
🌐 www.dubricks.com

EMAAR

